

ATTACHMENT G.25

This section is intentionally blank as a place holder.

~~ATTACHMENT G.25~~

~~TECHNICAL AREA 55, BUILDING 185  
INDOOR CONTAINER STORAGE UNIT  
CLOSURE PLAN~~

**TABLE OF CONTENTS**

LIST OF TABLES ..... iv  
LIST OF FIGURES ..... v  
1.0 INTRODUCTION ..... 1  
2.0 DESCRIPTION OF UNIT TO BE CLOSED ..... 1  
3.0 ESTIMATE OF MAXIMUM WASTE STORED ..... 1  
4.0 GENERAL CLOSURE REQUIREMENTS ..... 1  
    4.1 Closure Performance Standard ..... 1  
    4.2 Closure Schedule ..... 2  
5.0 CLOSURE PROCEDURES ..... 3  
    5.1 Removal of Waste ..... 3  
    5.2 Records Review and Structural Assessment ..... 3  
        5.2.1 Records Review ..... 3  
        5.2.2 Structural Assessment ..... 3  
    5.3 Decontamination and Removal of Structures and Related Equipment ..... 4  
        5.3.1 Removal of Structures and Related Equipment ..... 4  
        5.3.2 Decontamination of Structures and Related Equipment ..... 4  
    5.4 Equipment Used During Decontamination Activities ..... 4  
6.0 SAMPLING AND ANALYSIS PLAN ..... 4  
    6.1 Decontamination Verification Sampling Activities ..... 5  
    6.2 Sample Collection Procedures ..... 5  
        6.2.1 Wipe Sampling ..... 5  
        6.2.2 Solid Chip Sampling ..... 5  
        6.2.3 Cleaning of Sampling Equipment ..... 5  
    6.3 Sample Management Procedures ..... 6  
        6.3.1 Sample Documentation ..... 6  
            6.3.1.1 Chain of Custody ..... 6  
            6.3.1.2 Sample Labels and Custody Seals ..... 6  
            6.3.1.3 Sample Logbook ..... 7  
        6.3.2 Sample Handling, Preservation, and Storage ..... 7

6.3.3 Packaging and Transportation of Samples ..... 7

6.4 Sample Analysis Requirements ..... 7

6.4.1 Analytical Laboratory Requirements ..... 8

6.4.2 Quality Assurance/Quality Control ..... 8

6.4.2.1 Field Quality Control ..... 8

6.4.2.2 Analytical Laboratory QC Samples ..... 8

6.4.3 Data Reduction, Verification, Validation, and Reporting ..... 9

6.4.4 Data Reporting Requirements ..... 9

7.0 WASTE MANAGEMENT ..... 9

8.0 CLOSURE CERTIFICATION REPORT ..... 9

9.0 REFERENCES ..... 9

Formatted: Body Text,  
Space After: 3 pt

~~LIST OF TABLES~~

~~TABLE NO. TITLE~~

~~G.25-1 Closure Schedule for the Technical Area 55, Building 185, Indoor Container Storage Unit~~

~~G.25-2 Potential Waste Materials, Waste Types, and Disposal Options~~

~~G.25-3 Summary of Analytical Methods~~

~~G.25-4 Sample Containers, Preservation Techniques, and Holding Times~~

~~G.25-5 Quality Control Sample Types, Applicable Analyses, Frequency, and Acceptance Criteria~~

Formatted: Line spacing: 1.5 lines

Formatted: Body Text

Formatted: Body Text, Left, Indent: Left: 0", First line: 0", Space After: 0 pt

~~LIST OF FIGURES~~

~~FIGURE NO. TITLE~~

~~G.25-1 Technical Area 55, Building 185, Indoor Container Storage Unit Grid Sampling Locations~~

## ~~1.0 INTRODUCTION~~

~~THIS CLOSURE PLAN DESCRIBES THE ACTIVITIES NECESSARY TO CLOSE THE INDOOR HAZARDOUS WASTE CONTAINER STORAGE UNIT WHICH IS LOCATED IN BUILDING 185 AT TECHNICAL AREA 55 (TA-55-185) AT THE LOS ALAMOS NATIONAL LABORATORY (FACILITY), HEREINAFTER REFERRED TO AS THE PERMITTED UNIT. THE INFORMATION PROVIDED IN THIS CLOSURE PLAN ADDRESSES THE CLOSURE REQUIREMENTS SPECIFIED IN PERMIT PART 9, THE CODE OF FEDERAL REGULATIONS (CFR), TITLE 40, PART 264, SUBPARTS G AND I FOR HAZARDOUS WASTE MANAGEMENT UNITS OPERATED AT THE FACILITY UNDER THE RESOURCE CONSERVATION AND RECOVERY ACT (RCRA) AND THE NEW MEXICO HAZARDOUS WASTE ACT.~~

~~UNTIL CLOSURE IS COMPLETE AND HAS BEEN CERTIFIED IN ACCORDANCE WITH PERMIT SECTION 9.5, A COPY OF THE APPROVED CLOSURE PLAN OR THE HAZARDOUS WASTE FACILITY PERMIT CONTAINING THE PLAN, ANY APPROVED REVISIONS, AND CLOSURE ACTIVITY DOCUMENTATION ASSOCIATED WITH THE CLOSURE WILL BE ON FILE WITH HAZARDOUS WASTE COMPLIANCE PERSONNEL AT THE FACILITY AND AT THE U.S. DEPARTMENT OF ENERGY (DOE) LOS ALAMOS SITE OFFICE. PRIOR TO CLOSURE OF THE PERMITTED UNIT, THIS CLOSURE PLAN MAY BE AMENDED IN ACCORDANCE WITH PERMIT SECTION 9.4.8, AS NECESSARY AND APPROPRIATE, TO PROVIDE UPDATED SAMPLING AND ANALYSIS PLANS AND TO INCORPORATE UPDATED DECONTAMINATION TECHNOLOGIES. AMENDED CLOSURE PLANS SHALL BE SUBMITTED TO THE NEW MEXICO ENVIRONMENT DEPARTMENT (DEPARTMENT) FOR APPROVAL PRIOR TO IMPLEMENTING CLOSURE ACTIVITIES.~~

## ~~2.0 DESCRIPTION OF UNIT TO BE CLOSED~~

~~A SPECIFIC DESCRIPTION OF THE PERMITTED UNIT CAN BE FOUND IN PERMIT ATTACHMENT A (TECHNICAL AREA UNIT DESCRIPTIONS). ADDITIONAL FEATURES AND EQUIPMENT LOCATED AT THE PERMITTED UNIT AND NOT DISCUSSED ELSEWHERE WITHIN THE PERMIT ARE DESCRIBED BELOW.~~

~~THE RECTANGULAR SHAPED PERMITTED UNIT, WHICH IS LOCATED WEST OF TA-55 BUILDING 4, IS A STEEL-FRAMED BUILDING WITH A CONCRETE FLOOR THAT MEASURES 60 FEET (FT) BY 40 FT. THE PERMITTED UNIT IS COMPLETELY ENCLOSED EXCEPT FOR AN ACCESS DOORWAY ON ONE WALL AND A METAL ROLL UP DOOR AND ACCESS DOORWAY ON THE OPPOSITE WALL. THE WASTE TYPICALLY STORED AT THE PERMITTED UNIT CONSISTS GENERALLY OF HAZARDOUS AND MIXED WASTE IN SOLID FORM.~~

~~THE PERMITTED UNIT WAS CONSTRUCTED IN 1991 AND STORES HAZARDOUS WASTES THAT INCLUDE SLUDGE, DEBRIS, AND CHEMICAL WASTES WITH REGULATED METAL ORGANIC CONSTITUENTS. PERMIT PART 3 (STORAGE IN CONTAINERS), PERMIT ATTACHMENT A (TECHNICAL AREA UNIT DESCRIPTIONS), PERMIT ATTACHMENT B (PART A APPLICATION), AND PERMIT ATTACHMENT C (WASTE ANALYSIS PLAN) INCLUDE ADDITIONAL INFORMATION REGARDING~~

Formatted: Heading  
1, Closure Plan -Heading  
1

~~WASTE MANAGEMENT PROCEDURES AND HAZARDOUS WASTE CONSTITUENTS  
STORED AT THE PERMITTED UNIT.~~

~~3.0 ESTIMATE OF MAXIMUM WASTE STORED~~

~~TO DATE, NO HAZARDOUS WASTE HAS BEEN STORED AT THE PERMITTED UNIT.  
THROUGHOUT THE LIFE OF THIS PERMIT IT IS ESTIMATED THAT 1,000 CUBIC  
METERS OF WASTE WILL BE STORED IN THE PERMITTED UNIT.~~

~~4.0 GENERAL CLOSURE REQUIREMENTS~~

~~4.1 CLOSURE PERFORMANCE STANDARD~~

~~AS REQUIRED BY PERMIT SECTION 9.2, THE PERMITTED UNIT WILL BE CLOSED TO  
MEET THE FOLLOWING PERFORMANCE STANDARDS:~~

~~a. REMOVE ALL HAZARDOUS WASTE RESIDUES AND HAZARDOUS CONSTITUENTS;  
AND~~

~~b. ENSURE CONTAMINATED MEDIA DO NOT CONTAIN CONCENTRATIONS OF  
HAZARDOUS CONSTITUENTS GREATER THAN THE CLEAN UP LEVELS  
ESTABLISHED IN ACCORDANCE WITH PERMIT SECTIONS 11.4 AND 11.5. FOR  
SOILS THE CLEANUP LEVELS SHALL BE ESTABLISHED BASED ON RESIDENTIAL  
USE. THE PERMITTEES MUST ALSO DEMONSTRATE THAT THERE IS NO  
POTENTIAL TO CONTAMINATE GROUNDWATER.~~

~~IF THE PERMITTEES ARE UNABLE TO ACHIEVE EITHER OF THE CLEAN CLOSURE  
STANDARDS ABOVE, THEY MUST:~~

~~c. CONTROL HAZARDOUS WASTE RESIDUES, HAZARDOUS CONSTITUENTS, AND, AS  
APPLICABLE, CONTAMINATED MEDIA SUCH THAT THEY DO NOT EXCEED A  
TOTAL EXCESS CANCER RISK OF  $10^{-5}$  FOR CARCINOGENIC SUBSTANCES AND,  
FOR NON-CARCINOGENIC SUBSTANCES, A TARGET HAZARD INDEX OF 1.0 FOR  
HUMAN RECEPTORS, AND MEET ECOLOGICAL SCREENING LEVELS  
ESTABLISHED UNDER PERMIT SECTION 11.5;~~

~~d. MINIMIZE THE NEED FOR FURTHER MAINTENANCE;~~

~~e. CONTROL, MINIMIZE, OR ELIMINATE, TO THE EXTENT NECESSARY TO PROTECT  
HUMAN HEALTH AND THE ENVIRONMENT, THE POST-CLOSURE ESCAPE OF  
HAZARDOUS WASTE, HAZARDOUS CONSTITUENTS, LEACHATE, CONTAMINATED  
RUNOFF, OR HAZARDOUS WASTE DECOMPOSITION PRODUCTS TO THE GROUND,  
GROUNDWATER, SURFACE WATERS, OR TO THE ATMOSPHERE; AND~~

~~f. COMPLY WITH THE CLOSURE REQUIREMENTS OF PERMIT PART 9 (CLOSURE)  
AND 40 CFR PART 264 SUBPARTS G AND I FOR CONTAINER STORAGE UNITS.~~

~~CLOSURE OF THE PERMITTED UNIT WILL BE DEEMED COMPLETE WHEN: 1) ALL  
SURFACES AND EQUIPMENT HAVE BEEN DECONTAMINATED, OR OTHERWISE~~

Formatted: Heading  
1, Closure Plan -Heading  
1, Left, No bullets or  
numbering

Formatted: Heading  
1, Closure Plan -Heading  
1, Left

Formatted: Heading  
1, Closure Plan -Heading  
1, Left, No bullets or  
numbering

Formatted: Heading  
1, Closure Plan -Heading  
1

~~PROPERLY DISPOSED OF; 2) CLOSURE HAS BEEN CERTIFIED BY AN INDEPENDENT, PROFESSIONAL ENGINEER LICENSED IN THE STATE OF NEW MEXICO; AND 3) CLOSURE CERTIFICATION HAS BEEN SUBMITTED TO, AND APPROVED BY, THE DEPARTMENT.~~

#### ~~4.2 CLOSURE SCHEDULE~~

~~THIS CLOSURE PLAN SCHEDULE IS INTENDED TO ADDRESS CLOSURE REQUIREMENTS FOR THE PERMITTED UNIT WITHIN THE AUTHORIZED TIMEFRAME OF THE CURRENT HAZARDOUS WASTE FACILITY PERMIT (SEE PERMIT SECTION 9.4). THE FOLLOWING SECTION PROVIDES THE SCHEDULE OF CLOSURE ACTIVITIES (SEE ALSO TABLE G.25-2 OF THIS CLOSURE PLAN).~~

~~NOTIFICATION OF CLOSURE WILL OCCUR AT LEAST 45 DAYS BEFORE THE PERMITTEES EXPECT TO BEGIN CLOSURE (SEE 40 CFR § 264.112(D)(1)) AND CLOSURE ACTIVITIES WILL BEGIN ACCORDING TO THE REQUIREMENTS OF 40 CFR 264.112(D)(2). HOWEVER, PURSUANT TO 40 CFR § 264.112(E), REMOVING HAZARDOUS WASTES AND DECONTAMINATING OR DISMANTLING EQUIPMENT IN ACCORDANCE WITH AN APPROVED CLOSURE PLAN MAY BE CONDUCTED AT ANY TIME BEFORE OR AFTER NOTIFICATION OF CLOSURE. NOTIFICATION OF THE STRUCTURAL ASSESSMENT (ASSESSMENT), AS DESCRIBED IN SECTION 5.2 OF THIS CLOSURE PLAN, SHALL OCCUR IN ACCORDANCE WITH PERMIT SECTION 9.4.6.2.~~

~~WITHIN 90 DAYS AFTER THE FINAL RECEIPT OF HAZARDOUS WASTE, THE PERMITTED UNIT WILL BE EMPTIED OF ALL STORED WASTE. WITHIN TEN DAYS OF COMPLETING HAZARDOUS WASTE REMOVAL OR WITHIN 100 DAYS OF THE FINAL RECEIPT OF HAZARDOUS WASTE, THE PERMITTEES WILL CONDUCT THE RECORDS REVIEW (REVIEW) AND ASSESSMENT AND SUBMIT AN AMENDED CLOSURE PLAN, IF NECESSARY, TO THE DEPARTMENT FOR REVIEW AND APPROVAL AS A PERMIT MODIFICATION. UPON APPROVAL OF THE MODIFIED CLOSURE PLAN, IF APPLICABLE, THE PERMITTEES WILL DECONTAMINATE UNIT STRUCTURES, SURFACES, AND EQUIPMENT.~~

~~DECONTAMINATION VERIFICATION SAMPLING ACTIVITIES, AND SOIL SAMPLING IF APPLICABLE, WILL BE CONDUCTED TO DEMONSTRATE THAT STRUCTURES, SURFACES, RELATED EQUIPMENT, AND MEDIA, IF APPLICABLE, AT THE PERMITTED UNIT MEET THE CLOSURE PERFORMANCE STANDARDS IN PERMIT SECTION 9.2.~~

~~ALL CLOSURE ACTIVITIES, INCLUDING SUBMITTAL OF A FINAL CLOSURE CERTIFICATION REPORT TO THE DEPARTMENT FOR REVIEW AND APPROVAL, WILL BE COMPLETED WITHIN 180 DAYS AFTER THE FINAL RECEIPT OF WASTE. IN THE EVENT THAT CLOSURE OF THE PERMITTED UNIT CANNOT PROCEED ACCORDING TO SCHEDULE, THE PERMITTEES WILL NOTIFY THE DEPARTMENT IN ACCORDANCE WITH THE EXTENSION REQUEST REQUIREMENTS IN PERMIT SECTION 9.4.1.1.~~

#### ~~5.0 CLOSURE PROCEDURES~~



~~CLOSURE ACTIVITIES AT THE PERMITTED UNIT WILL INCLUDE: REMOVAL OF HAZARDOUS WASTES; PROPER MANAGEMENT AND DISPOSAL OF HAZARDOUS WASTE RESIDUES AND CONTAMINATED SURFACES, STRUCTURES, AND EQUIPMENT ASSOCIATED WITH THE PERMITTED UNIT; VERIFICATION THAT THE CLOSURE PERFORMANCE STANDARDS IN PERMIT SECTION 9.2 HAVE BEEN ACHIEVED; AND SUBMITTAL OF A FINAL CLOSURE CERTIFICATION REPORT. THE FOLLOWING SECTIONS DESCRIBE CLOSURE ACTIVITIES APPLICABLE TO THE PERMITTED UNIT.~~

#### ~~5.1—REMOVAL OF WASTE~~

~~IN ACCORDANCE WITH PERMIT SECTION 9.4.2, ALL STORED HAZARDOUS WASTES WILL BE REMOVED FROM THE PERMITTED UNIT SCHEDULED FOR CLOSURE. DEPENDING UPON THEIR SIZE, CONTAINERS WILL BE REMOVED WITH FORKLIFTS, CONTAINER DOLLIES, AIR PALLETS, OR MANUALLY. CONTAINERS WILL BE PLACED ON FLAT BED TRUCKS, TRAILERS, OR OTHER APPROPRIATE VEHICLES FOR TRANSPORT. APPROPRIATE SHIPPING DOCUMENTATION WILL ACCOMPANY THE WASTES DURING TRANSPORT. CONTAINERS HOLDING HAZARDOUS WASTES WILL BE MOVED TO A PERMITTED ON-SITE STORAGE UNIT OR A PERMITTED OFF-SITE TREATMENT, STORAGE, OR DISPOSAL FACILITY.~~

#### ~~5.2—RECORDS REVIEW AND STRUCTURAL ASSESSMENT~~

~~AFTER WASTE REMOVAL AND BEFORE STARTING CLOSURE DECONTAMINATION AND SAMPLING ACTIVITIES, THE FACILITY OPERATING AND INSPECTION RECORDS FOR THE PERMITTED UNIT WILL BE REVIEWED AND AN ASSESSMENT WILL BE CONDUCTED TO DETERMINE ANY PREVIOUS FINDING(S) OR ACTION(S) THAT MAY INFLUENCE CLOSURE ACTIVITIES OR POTENTIAL SAMPLING LOCATIONS.~~

##### ~~5.2.1—RECORDS REVIEW~~

~~THE FACILITY OPERATING AND INSPECTION RECORDS SHALL BE REVIEWED AS OUTLINED IN PERMIT SECTION 9.4.6.1. THE GOALS OF THE REVIEW WILL BE TO:~~

- ~~a.—CONFIRM THE SPECIFIC HAZARDOUS WASTE CONSTITUENTS OF CONCERN; AND~~
- ~~b.—CONFIRM ADDITIONAL SAMPLING LOCATIONS (E.G., LOCATIONS OF SPILLS OR CHRONIC CONDITIONS IDENTIFIED IN THE OPERATING AND INSPECTION RECORDS);~~

##### ~~5.2.2—STRUCTURAL ASSESSMENT~~

~~AN ASSESSMENT OF THE PERMITTED UNIT'S PHYSICAL CONDITION WILL BE CONDUCTED IN ACCORDANCE WITH PERMIT SECTION 9.4.6.2. THE ASSESSMENT WILL INCLUDE INSPECTING THE FLOOR, AND WALLS FOR ANY EXISTING CRACKS OR CONDITIONS THAT INDICATE A POTENTIAL FOR RELEASE OF CONSTITUENTS. IF A CRACK, GAP, OR STAINED AREA IS PRESENT, THE~~

Formatted: Heading 1, Closure Plan -Heading 1, Left, No bullets or numbering

Formatted: Heading 1, Closure Plan -Heading 1

~~PERMITTEES WILL AMEND THIS CLOSURE PLAN IN ORDER TO UPDATE THE SAMPLING AND ANALYSIS PLAN (SAP) (SEE SECTION 6.0 OF THIS CLOSURE PLAN) TO ADD THESE SAMPLING LOCATIONS AND THE APPLICABLE SAMPLING METHODS AND PROCEDURES. THIS INSPECTION WILL BE DOCUMENTED WITH PHOTOGRAPHS AND DRAWINGS, AS NECESSARY.~~

### ~~5.3 DECONTAMINATION AND REMOVAL OF STRUCTURES AND RELATED EQUIPMENT~~

~~IN ACCORDANCE WITH PERMIT SECTION 9.4.3, ALL REMAINING HAZARDOUS WASTE AND HAZARDOUS WASTE RESIDUES WILL BE REMOVED FROM THE PERMITTED UNIT. THE PERMITTED UNIT'S SURFACES, STRUCTURES, AND EQUIPMENT WILL BE DECONTAMINATED, REMOVED, OR BOTH AND MANAGED APPROPRIATELY. ALL WASTE MATERIAL WILL BE CONTROLLED, HANDLED, CHARACTERIZED, AND DISPOSED OF IN ACCORDANCE WITH PERMIT ATTACHMENT C (WASTE ANALYSIS PLAN), PERMIT SECTION 9.4.5, AND FACILITY WASTE MANAGEMENT PROCEDURES.~~

#### ~~5.3.1 REMOVAL OF STRUCTURES AND RELATED EQUIPMENT~~

~~ALL SURFACES AND RELATED EQUIPMENT THAT ARE REMOVED WILL NOT REQUIRE DECONTAMINATION, WILL BE CONSIDERED SOLID AND POTENTIALLY HAZARDOUS WASTE (AS DEFINED BY THIS PERMIT) WHEN REMOVED, AND WILL BE DISPOSED OF IN ACCORDANCE WITH PERMIT SECTION 9.4.5 AND SECTION 7.0 OF THIS CLOSURE PLAN. TO DATE, NO EQUIPMENT HAS BEEN USED AT THE PERMITTED UNIT.~~

#### ~~5.3.2 DECONTAMINATION OF STRUCTURES AND RELATED EQUIPMENT~~

~~ALL SURFACES AND RELATED EQUIPMENT THAT WILL BE LEFT IN PLACE OR REUSED BY THE FACILITY WILL BE DECONTAMINATED IN ACCORDANCE WITH PERMIT SECTION 9.4.3.1. AT THIS TIME THERE IS NO EQUIPMENT LOCATED AT THE UNIT THAT IS EXPECTED TO BE DECONTAMINATED; HOWEVER, IF EQUIPMENT IS IDENTIFIED DURING THE ASSESSMENT IT WILL BE DECONTAMINATED IN ACCORDANCE WITH THIS SECTION.~~

~~DECONTAMINATION OF THE SURFACES OF THE PERMITTED UNIT WILL INCLUDE ALL FEATURES LOCATED WITHIN THE UNIT (E.G., WALLS, CEILINGS, RAILINGS). THE ENTIRETY OF THE UNIT'S FLOOR AND WALLS (UP TO 11 FT.) WILL BE DECONTAMINATED BY PRESSURE WASHING OR STEAM CLEANING WITH A SOLUTION CONSISTING OF A SURFACTANT DETERGENT (E.G., ALCONOX<sup>®</sup>) AND WATER MIXED IN ACCORDANCE WITH THE MANUFACTURER'S RECOMMENDATIONS. PORTABLE BERMS OR OTHER DEVICES (E.G., ABSORBENT SOCKS, PLASTIC SHEETING, WADING POOLS, OR EXISTING SECONDARY CONTAINMENT) WILL COLLECT EXCESS WATER AND PROVIDE CONTAINMENT DURING THE DECONTAMINATION PROCESS.~~

### ~~5.4 EQUIPMENT USED DURING DECONTAMINATION ACTIVITIES~~

~~REUSABLE PROTECTIVE CLOTHING, TOOLS, AND EQUIPMENT USED DURING CLOSURE DECONTAMINATION ACTIVITIES WILL BE CLEANED WITH A WASH WATER SOLUTION. RESIDUES, DISPOSABLE EQUIPMENT, AND SMALL REUSABLE EQUIPMENT THAT CANNOT BE DECONTAMINATED WILL BE CONTAINERIZED AND MANAGED AS WASTE AS SUMMARIZED IN TABLE G.25-2 AND IN ACCORDANCE WITH PERMIT SECTION 9.4.5 AND SECTION 7.0 OF THIS CLOSURE PLAN.~~

## ~~6.0 SAMPLING AND ANALYSIS PLAN~~

~~THIS SAP ADDRESSES THE SPECIFIC CLOSURE SAMPLING AND ANALYSIS REQUIREMENTS IN PERMIT SECTION 9.4.7 AND DESCRIBES THE SAMPLING, ANALYSIS, AND QUALITY ASSURANCE/QUALITY CONTROL (QA/QC) METHODS THAT WILL BE USED TO DEMONSTRATE THAT THE PERMITTEES HAVE MET THE CLOSURE PERFORMANCE STANDARDS OUTLINED IN PERMIT SECTION 9.2.~~

Formatted: Heading 1, Closure Plan -Heading 1, Left

### ~~6.1 DECONTAMINATION VERIFICATION SAMPLING ACTIVITIES~~

~~DECONTAMINATION VERIFICATION SAMPLING ACTIVITIES WILL BE CONDUCTED AT THE PERMITTED UNIT IN ORDER TO VERIFY THAT SURFACES AND RELATED EQUIPMENT AT THE PERMITTED UNIT MEET THE CLOSURE PERFORMANCE STANDARDS IN PERMIT SECTION 9.2. ALL SAMPLES WILL BE COLLECTED AND ANALYZED IN ACCORDANCE WITH THE PROCEDURES IN SECTIONS 6.2, 6.3, AND 6.4 OF THIS CLOSURE PLAN.~~

Formatted: Heading 1, Closure Plan -Heading 1

Formatted: Heading 1, Closure Plan -Heading 1, Left

~~ONE WIPE SAMPLE WILL BE COLLECTED FROM EACH PIECE OF DECONTAMINATED EQUIPMENT AT THE PERMITTED UNIT. IN COMPLIANCE WITH PERMIT SECTION 9.4.7.1.1, THIS CLOSURE PLAN WILL ENSURE THE COLLECTION OF AT LEAST SIX WIPE SAMPLES FROM THE FLOOR, TWO EACH FROM THE LONG WALLS (UP TO 11 FEET), AND ONE EACH FROM THE SHORT WALLS (UP TO 11 FEET) FOR A TOTAL OF 12 WIPE SAMPLES (SEE FIGURE G.25-1).~~

~~SOLID CHIP SAMPLES MAY BE COLLECTED AND ANALYZED TO DETERMINE IF RESIDUAL HAZARDOUS CONSTITUENTS REMAIN IN THE CONCRETE FLOOR AT THE PERMITTED UNIT.~~

### ~~6.2 SAMPLE COLLECTION PROCEDURES~~

Formatted: Heading 1, Closure Plan -Heading 1

~~SAMPLES WILL BE COLLECTED IN ACCORDANCE WITH PERMIT SECTION 9.4.7.1 AND THE PROCEDURES IDENTIFIED IN THIS SAP WHICH INCORPORATES GUIDANCE FROM THE UNITED STATES ENVIRONMENTAL PROTECTION AGENCY (USEPA) (EPA, 2002), DOE (DOE, 1995), AND OTHER DEPARTMENT-APPROVED PROCEDURES.~~

#### ~~6.2.1 WIPE SAMPLING~~

~~SURFACE WIPE SAMPLES WILL BE COLLECTED AND ANALYZED TO DETERMINE IF RESIDUAL HAZARDOUS CONSTITUENTS REMAIN ON THE SURFACES AND RELATED EQUIPMENT AT THE PERMITTED UNIT. SAMPLES WILL BE~~

Formatted: Heading 1, Closure Plan -Heading 1, Left

~~COLLECTED IN ACCORDANCE WITH THE NATIONAL INSTITUTE OF OCCUPATIONAL SAFETY AND HEALTH (NIOSH) MANUAL OF ANALYTICAL METHODS (NIOSH, 1994). THE APPROPRIATE WIPE SAMPLE METHOD WILL CONSIDER THE TYPE OF SURFACE BEING SAMPLED, THE TYPE OF CONSTITUENT BEING SAMPLED FOR, THE SOLUTION USED, AND THE DESIRED CONSTITUENT CONCENTRATION DETECTION LIMIT.~~

~~THE NIOSH METHOD INCLUDES WIPING A 100 SQUARE CENTIMETER AREA AT EACH DISCRETE LOCATION WITH A GAUZE WIPE WETTED WITH A LIQUID SOLUTION APPROPRIATE FOR THE DESIRED ANALYSIS (E.G., DEIONIZED WATER FOR LEAD). FOR WIPE SAMPLING, GUIDANCE FROM THE ANALYTICAL LABORATORY MUST BE OBTAINED PRIOR TO WIPE VERIFICATION SAMPLING TO CONFIRM THAT THE SOLUTION CHOSEN FOR EACH ANALYSIS IS APPROPRIATE FOR THE ANALYSIS TO BE CONDUCTED AND THAT WIPE SAMPLING IS A PROPER TECHNIQUE FOR THE ANALYSIS.~~

#### ~~6.2.2 — SOLID CHIP SAMPLING~~

~~SOLID CHIP SAMPLES MAY BE COLLECTED AND ANALYZED TO DETERMINE IF RESIDUAL HAZARDOUS CONSTITUENTS REMAIN IN THE CONCRETE FLOOR AT THE PERMITTED UNIT. ANY NON-POROUS INCLUSIONS FROM THE SAMPLING LOCATION WILL BE REMOVED BY BRUSHING OR WIPING. USING A CHISEL, DRILL, HOLE SAW, OR SIMILAR TOOL, A MINIMUM 100 GRAMS OF THE SAMPLE WILL BE COLLECTED TO A DEPTH OF 2 CM, OR TO AN ALTERNATE DEPTH SPECIFIED IN THE ASSESSMENT AND TRANSFERRED TO AN APPROPRIATE SAMPLING CONTAINER. THE HOLDING TIME AND THE PRESERVATION TECHNIQUES TO BE USED FOR EACH ANALYSIS WILL BE DETERMINED FROM TABLE G.25-4.~~

#### ~~6.2.3 — CLEANING OF SAMPLING EQUIPMENT~~

~~REUSABLE SAMPLING EQUIPMENT WILL BE CLEANED AND RINSED PRIOR TO USE. SAMPLING EQUIPMENT RINSATE BLANKS WILL BE COLLECTED AND ANALYZED ONLY IF REUSABLE SAMPLING EQUIPMENT IS USED. REUSABLE DECONTAMINATION EQUIPMENT, INCLUDING PROTECTIVE CLOTHING AND TOOLS, USED DURING CLOSURE ACTIVITIES WILL BE SCRAPED AS NECESSARY TO REMOVE RESIDUE AND CLEANED WITH A WASH WATER SOLUTION. SAMPLING EQUIPMENT WILL BE CLEANED PRIOR TO EACH USE WITH A WASH SOLUTION, RINSED SEVERAL TIMES WITH TAP WATER, AND AIR DRIED TO PREVENT CROSS-CONTAMINATION OF SAMPLES. A DISPOSABLE SAMPLER IS CONSIDERED CLEAN IF STILL IN A FACTORY SEALED WRAPPER.~~

#### ~~6.3 — SAMPLE MANAGEMENT PROCEDURES~~

~~THE FOLLOWING SECTIONS PROVIDE A DESCRIPTION OF SAMPLE DOCUMENTATION, HANDLING, PRESERVATION, STORAGE, PACKAGING, AND TRANSPORTATION REQUIREMENTS THAT WILL BE FOLLOWED DURING THE SAMPLING ACTIVITIES ASSOCIATED WITH THE CLOSURE.~~

Formatted: Heading 1,Closure Plan -Heading 1

Formatted: Heading 1,Closure Plan -Heading 1, Left

Formatted: Heading 1,Closure Plan -Heading 1

Formatted: Heading 1,Closure Plan -Heading 1, Left

**6.3.1 — SAMPLE DOCUMENTATION**

~~SAMPLING PERSONNEL WILL COMPLETE AND MAINTAIN RECORDS TO DOCUMENT SAMPLING AND ANALYSIS ACTIVITIES. SAMPLE DOCUMENTATION WILL INCLUDE SAMPLE IDENTIFICATION NUMBERS, CHAIN-OF-CUSTODY FORMS, ANALYSIS REQUESTED, SAMPLE LOGBOOKS DETAILING SAMPLE COLLECTION ACTIVITIES, AND SHIPPING FORMS (IF NECESSARY).~~

**6.3.1.1 CHAIN-OF-CUSTODY**

~~CHAIN-OF-CUSTODY FORMS WILL BE MAINTAINED BY SAMPLING PERSONNEL UNTIL SAMPLES ARE RELINQUISHED TO THE ANALYTICAL LABORATORY. THIS WILL ENSURE THE INTEGRITY OF THE SAMPLES AND PROVIDE FOR AN ACCURATE AND DEFENSIBLE WRITTEN RECORD OF THE SAMPLING POSSESSION AND HANDLING FROM THE TIME OF COLLECTION UNTIL LABORATORY ANALYSIS. ONE CHAIN-OF-CUSTODY FORM MAY BE USED TO DOCUMENT ALL OF THE SAMPLES COLLECTED FROM A SINGLE SAMPLING EVENT. THE SAMPLE COLLECTOR WILL BE RESPONSIBLE FOR THE INTEGRITY OF THE SAMPLES COLLECTED UNTIL PROPERLY TRANSFERRED TO ANOTHER PERSON. THE EPA CONSIDERS A SAMPLE TO BE IN A PERSON'S CUSTODY IF IT IS:~~

- ~~a. IN A PERSON'S PHYSICAL POSSESSION;~~
- ~~b. IN VIEW OF THE PERSON IN POSSESSION; OR~~
- ~~c. SECURED BY THAT PERSON IN A RESTRICTED ACCESS AREA TO PREVENT TAMPERING.~~

~~THE SAMPLE COLLECTOR WILL DOCUMENT ALL PERTINENT SAMPLE COLLECTION DATA. INDIVIDUALS RELINQUISHING OR RECEIVING CUSTODY OF THE SAMPLES WILL SIGN, DATE, AND NOTE THE TIME ON THE ANALYSIS REQUEST AND CHAIN-OF-CUSTODY FORM. A CHAIN-OF-CUSTODY FORM MUST ACCOMPANY ALL SAMPLES FROM COLLECTION THROUGH LABORATORY ANALYSIS. THE ANALYTICAL LABORATORY WILL RETURN THE COMPLETED CHAIN-OF-CUSTODY FORM TO THE FACILITY AND IT WILL BECOME PART OF THE PERMANENT SAMPLING RECORD DOCUMENTING THE SAMPLING EFFORTS.~~

**6.3.1.2 SAMPLE LABELS AND CUSTODY SEALS**

~~A SAMPLE LABEL WILL BE AFFIXED TO EACH SAMPLE CONTAINER. THE SAMPLE LABEL WILL INCLUDE THE FOLLOWING INFORMATION:~~

- ~~a. A UNIQUE SAMPLE IDENTIFICATION NUMBER;~~
- ~~b. NAME OF THE SAMPLE COLLECTOR;~~
- ~~c. DATE AND TIME OF COLLECTION;~~
- ~~d. TYPE OF PRESERVATIVES USED, IF ANY; AND~~

Formatted: Heading 1,Closure Plan -Heading 1

Formatted: Heading 1,Closure Plan -Heading 1, Left

Formatted: Heading 1,Closure Plan -Heading 1

Formatted: Heading 1,Closure Plan -Heading 1, Left, Space After: 0 pt

Formatted: Heading 1,Closure Plan -Heading 1, Left, Space After: 0 pt, No bullets or numbering

Formatted: Heading 1,Closure Plan -Heading 1, Left, No bullets or numbering

Formatted: Heading 1,Closure Plan -Heading 1, Left

Formatted: Heading 1,Closure Plan -Heading 1

Formatted: Heading 1,Closure Plan -Heading 1, Left, Space After: 0 pt

Formatted: Heading 1,Closure Plan -Heading 1, Left, Space After: 0 pt, No bullets or numbering

~~e. LOCATION FROM WHICH THE SAMPLE WAS COLLECTED.~~

~~A CUSTODY SEAL WILL BE PLACED ON EACH SAMPLE CONTAINER TO DETECT UNAUTHORIZED TAMPERING WITH THE SAMPLES. THESE LABELS MUST BE INITIALED, DATED, AND AFFIXED BY THE SAMPLE COLLECTOR IN SUCH A MANNER THAT IT IS NECESSARY TO BREAK THE SEAL TO OPEN THE CONTAINER.~~

~~6.3.1.3 SAMPLE LOGBOOK~~

~~ALL PERTINENT INFORMATION ON THE SAMPLING EFFORT MUST BE RECORDED IN A BOUND LOGBOOK. INFORMATION MUST BE RECORDED IN INK AND ANY CROSS-OUTS MUST BE MADE WITH A SINGLE LINE WITH THE CHANGE INITIALED AND DATED BY THE AUTHOR. THE SAMPLE LOGBOOK WILL INCLUDE THE FOLLOWING INFORMATION:~~

- ~~a. THE SAMPLE LOCATION;~~
- ~~b. SUSPECTED COMPOSITION;~~
- ~~c. SAMPLE IDENTIFICATION NUMBER;~~
- ~~d. VOLUME/MASS OF SAMPLE TAKEN;~~
- ~~e. PURPOSE OF SAMPLING;~~
- ~~f. DESCRIPTION OF SAMPLE POINT AND SAMPLING METHODOLOGY;~~
- ~~g. DATE AND TIME OF COLLECTION;~~
- ~~h. NAME OF THE SAMPLE COLLECTOR;~~
- ~~i. SAMPLE DESTINATION AND HOW IT WILL BE TRANSPORTED;~~
- ~~j. OBSERVATIONS; AND~~
- ~~k. NAME(S) OF PERSONNEL RESPONSIBLE FOR THE OBSERVATIONS.~~

~~6.3.2 SAMPLE HANDLING, PRESERVATION, AND STORAGE~~

~~SAMPLES WILL BE COLLECTED AND CONTAINERIZED IN APPROPRIATE PRE-CLEANED SAMPLE CONTAINERS. TABLE G.25-4 PRESENTS THE REQUIREMENTS IN SW-846 (EPA, 1986) FOR SAMPLE CONTAINERS, PRESERVATION TECHNIQUES, AND HOLDING TIMES. SAMPLES THAT REQUIRE COOLING TO 4 DEGREES CELSIUS WILL BE PLACED IN A COOLER WITH ICE OR ICE GEL OR IN A REFRIGERATOR IMMEDIATELY UPON COLLECTION.~~

~~6.3.3 PACKAGING AND TRANSPORTATION OF SAMPLES~~

Formatted: Heading 1, Closure Plan -Heading 1, Left, No bullets or numbering

Formatted: Heading 1, Closure Plan -Heading 1, Left

Formatted: Heading 1, Closure Plan -Heading 1

Formatted: Heading 1, Closure Plan -Heading 1, Left, Space After: 0 pt

Formatted: Heading 1, Closure Plan -Heading 1, Left, Space After: 0 pt, No bullets or numbering

Formatted: Heading 1, Closure Plan -Heading 1, Left, No bullets or numbering

Formatted: Heading 1, Closure Plan -Heading 1

Formatted: Heading 1, Closure Plan -Heading 1, Left

Formatted: Heading 1, Closure Plan -Heading 1

~~ALL PACKAGING AND TRANSPORTATION ACTIVITIES WILL MEET SAFETY EXPECTATIONS, QA REQUIREMENTS, DOE ORDERS, AND RELEVANT LOCAL, STATE, AND FEDERAL LAWS (INCLUDING 10 CFR AND 49 CFR). APPROPRIATE FACILITY DOCUMENTS ESTABLISH THE REQUIREMENTS FOR PACKAGING DESIGN, TESTING, ACQUISITION, ACCEPTANCE, USE, MAINTENANCE, AND DECOMMISSIONING AND FOR ON-SITE, INTRA-SITE, AND OFF-SITE SHIPMENT PREPARATION AND TRANSPORTATION OF GENERAL COMMODITIES, HAZARDOUS MATERIALS, SUBSTANCES, WASTES, AND DEFENSE PROGRAM MATERIALS.~~

Formatted: Heading 1, Closure Plan -Heading 1, Left

~~OFF-SITE TRANSPORTATION OF SAMPLES WILL OCCUR VIA PRIVATE, CONTRACT, OR COMMON MOTOR CARRIER, AIR CARRIER, OR FREIGHT. ALL OFF-SITE TRANSPORTATION WILL BE PROCESSED THROUGH THE FACILITY PACKAGING AND TRANSPORTATION ORGANIZATION UNLESS THE SHIPPER IS SPECIFICALLY AUTHORIZED THROUGH FORMAL DOCUMENTATION BY THE PACKAGING AND TRANSPORTATION ORGANIZATION TO INDEPENDENTLY TENDER SHIPMENTS TO COMMON MOTOR OR AIR CARRIERS.~~

#### ~~6.4 SAMPLE ANALYSIS REQUIREMENTS~~

Formatted: Heading 1, Closure Plan -Heading 1

~~SAMPLES WILL BE ANALYZED FOR ALL HAZARDOUS CONSTITUENTS LISTED IN APPENDIX VIII OF 40 CFR PART 261 AND IN APPENDIX IX OF 40 CFR PART 264 THAT HAVE BEEN STORED AT THE PERMITTED UNIT OVER ITS OPERATIONAL HISTORY. SAMPLES WILL BE ANALYZED BY AN INDEPENDENT LABORATORY USING THE METHODS OUTLINED IN TABLE G.25-3. ANALYTES, TEST METHODS AND INSTRUMENTATION, TARGET DETECTION LIMITS, AND RATIONALE FOR METALS AND ORGANIC ANALYSES ARE PRESENTED IN TABLE G.25-3. IF ANY OF THE INFORMATION FROM THESE TABLES HAS CHANGED AT THE TIME OF CLOSURE, THE PERMITTEES WILL AMEND THIS CLOSURE PLAN TO UPDATE ALL METHODS IN THIS SAP.~~

Formatted: Heading 1, Closure Plan -Heading 1, Left

#### ~~6.4.1 ANALYTICAL LABORATORY REQUIREMENTS~~

Formatted: Heading 1, Closure Plan -Heading 1

~~THE ANALYTICAL LABORATORY WILL PERFORM THE DETAILED QUALITATIVE AND QUANTITATIVE CHEMICAL ANALYSES SPECIFIED IN SECTION 6.4.2. THIS ANALYTICAL LABORATORY WILL HAVE:~~

Formatted: Heading 1, Closure Plan -Heading 1, Left, Space After: 0 pt

- ~~a. A DOCUMENTED COMPREHENSIVE QA/QC PROGRAM;~~
- ~~b. TECHNICAL ANALYTICAL EXPERTISE;~~
- ~~c. A DOCUMENT CONTROL AND RECORDS MANAGEMENT PLAN; AND~~
- ~~d. THE CAPABILITY TO PERFORM DATA REDUCTION, VALIDATION, AND REPORTING.~~

Formatted: Heading 1, Closure Plan -Heading 1, Left, Space After: 0 pt, No bullets or numbering

~~THE SELECTION OF THE ANALYTICAL TESTING METHODS IDENTIFIED IN TABLE G.25-3 IS BASED ON THE FOLLOWING CONSIDERATIONS:~~

Formatted: Heading 1, Closure Plan -Heading 1, Left, No bullets or numbering

Formatted: Heading 1, Closure Plan -Heading 1, Left, Space After: 0 pt

~~e. THE PHYSICAL FORM OF THE WASTE;~~

~~f. CONSTITUENTS OF CONCERN;~~

~~g. REQUIRED DETECTION LIMITS (E.G., REGULATORY THRESHOLDS); AND~~

~~h. INFORMATION REQUIREMENTS (E.G., WASTE CLASSIFICATION).~~

#### ~~6.4.2 QUALITY ASSURANCE/QUALITY CONTROL~~

~~ALL SAMPLING AND ANALYSIS WILL BE CONDUCTED IN ACCORDANCE WITH QA/QC PROCEDURES DEFINED BY THE LATEST REVISION OF "TEST METHODS FOR EVALUATING SOLID WASTE, PHYSICAL/CHEMICAL METHODS" (SW-846) (EPA, 1986) OR OTHER DEPARTMENT-APPROVED PROCEDURES. FIELD SAMPLING PROCEDURES AND LABORATORY ANALYSES WILL BE EVALUATED THROUGH THE USE OF QA/QC SAMPLES TO ASSESS THE OVERALL QUALITY OF THE DATA PRODUCED. QC SAMPLES EVALUATE PRECISION, ACCURACY, AND POTENTIAL SAMPLE CONTAMINATION ASSOCIATED WITH THE SAMPLING AND ANALYSIS PROCESS, AND IS DESCRIBED IN THE FOLLOWING SECTIONS, ALONG WITH INFORMATION ON CALCULATIONS NECESSARY TO EVALUATE THE QC RESULTS.~~

##### ~~6.4.2.1 FIELD QUALITY CONTROL~~

~~THE FIELD QC SAMPLES THAT WILL BE COLLECTED ARE TRIP BLANKS, FIELD BLANKS, FIELD DUPLICATES, AND EQUIPMENT RINSATE BLANKS. TABLE G.25-5 PRESENTS A SUMMARY OF QC SAMPLE TYPES, APPLICABLE ANALYSES, FREQUENCY, AND ACCEPTANCE CRITERIA. QC SAMPLES WILL BE GIVEN A UNIQUE SAMPLE IDENTIFICATION NUMBER AND SUBMITTED TO THE ANALYTICAL LABORATORY AS BLIND SAMPLES. QC SAMPLES WILL BE IDENTIFIED ON THE APPLICABLE FORMS SO THAT THE RESULTS CAN BE APPLIED TO THE ASSOCIATED SAMPLE.~~

##### ~~6.4.2.2 ANALYTICAL LABORATORY QC SAMPLES~~

~~QA/QC CONSIDERATIONS ARE AN INTEGRAL PART OF ANALYTICAL LABORATORY OPERATIONS. LABORATORY QA ENSURES THAT ANALYTICAL METHODS GENERATE DATA THAT ARE TECHNICALLY SOUND, STATISTICALLY VALID, AND THAT CAN BE DOCUMENTED. QC PROCEDURES ARE THE TOOLS EMPLOYED TO MEASURE THE DEGREE TO WHICH THESE QA OBJECTIVES ARE MET.~~

#### ~~6.4.3 DATA REDUCTION, VERIFICATION, VALIDATION, AND REPORTING~~

~~ANALYTICAL DATA GENERATED BY THE ACTIVITIES DESCRIBED IN THIS CLOSURE PLAN WILL BE VERIFIED AND VALIDATED. DATA REDUCTION IS THE CONVERSION OF RAW DATA TO REPORTABLE UNITS, TRANSFER OF DATA BETWEEN RECORDING MEDIA, AND COMPUTATION OF SUMMARY STATISTICS, STANDARD ERRORS, CONFIDENCE INTERVALS, AND STATISTICAL TESTS.~~

#### ~~6.4.4 DATA REPORTING REQUIREMENTS~~

Formatted: Heading 1, Closure Plan -Heading 1, Left, Space After: 0 pt, No bullets or numbering

Formatted: Heading 1, Closure Plan -Heading 1, Left, No bullets or numbering

Formatted: Heading 1, Closure Plan -Heading 1

Formatted: Heading 1, Closure Plan -Heading 1, Left

Formatted: Heading 1, Closure Plan -Heading 1

Formatted: Heading 1, Closure Plan -Heading 1, Left

Formatted: Heading 1, Closure Plan -Heading 1

Formatted: Heading 1, Closure Plan -Heading 1, Left

Formatted: Heading 1, Closure Plan -Heading 1

Formatted: Heading 1, Closure Plan -Heading 1, Left

Formatted: Heading 1, Closure Plan -Heading 1



~~ANALYTICAL RESULTS WILL INCLUDE ALL PERTINENT INFORMATION ABOUT THE CONDITION AND APPEARANCE OF THE SAMPLE AS RECEIVED. ANALYTICAL REPORTS WILL INCLUDE:~~

Formatted: Heading 1, Closure Plan -Heading 1, Left, Space After: 0 pt

~~a. A SUMMARY OF ANALYTICAL RESULTS FOR EACH SAMPLE;~~

Formatted: Heading 1, Closure Plan -Heading 1, Left, Space After: 0 pt, No bullets or numbering

~~b. RESULTS FROM QC SAMPLES SUCH AS BLANKS, SPIKES, AND CALIBRATIONS;~~

~~c. REFERENCE TO STANDARD METHODS OR A DETAILED DESCRIPTION OF ANALYTICAL PROCEDURES; AND~~

~~d. RAW DATA PRINTOUTS FOR COMPARISON WITH SUMMARIES.~~

~~THE LABORATORY WILL DESCRIBE SAMPLE PREPARATIONS THAT OCCUR DURING THE ANALYSIS IN SUFFICIENT DETAIL SO THAT THE DATA USER CAN UNDERSTAND HOW THE SAMPLE WAS ANALYZED.~~

Formatted: Heading 1, Closure Plan -Heading 1

#### ~~7.0 WASTE MANAGEMENT~~

~~ALL WASTE GENERATED DURING CLOSURE WILL BE CONTROLLED, HANDLED, CHARACTERIZED, AND DISPOSED OF IN ACCORDANCE WITH PERMIT SECTION 9.4.5, PERMIT ATTACHMENT C (WASTE ANALYSIS PLAN), AND FACILITY WASTE MANAGEMENT PROCEDURES. CLOSURE ACTIVITIES MAY GENERATE DIFFERENT TYPES OF WASTE MATERIALS; THESE WASTES ARE LISTED WITH POTENTIAL DISPOSAL OPTIONS IN TABLE G.25-2 OF THIS CLOSURE PLAN. SUBSEQUENT DISPOSITION OPTIONS FOR THE DECONTAMINATED STRUCTURES AND EQUIPMENT INCLUDE REUSE, RECYCLING, OR DISPOSAL. REUSABLE PROTECTIVE CLOTHING, TOOLS, AND EQUIPMENT USED DURING DECONTAMINATION WILL BE CLEANED WITH A WASH WATER SOLUTION. DISPOSABLE EQUIPMENT AND OTHER SMALL EQUIPMENT THAT CANNOT BE DECONTAMINATED, AS SUMMARIZED IN TABLE G.25-2, WILL BE CONTAINERIZED AND MANAGED AS WASTE.~~

Formatted: Heading 1, Closure Plan -Heading 1, Left

#### ~~8.0 CLOSURE CERTIFICATION REPORT~~

~~UPON COMPLETION OF THE CLOSURE ACTIVITIES AT THE PERMITTED UNIT, A CLOSURE CERTIFICATION REPORT WILL BE PREPARED AND SUBMITTED TO THE DEPARTMENT FOR REVIEW AND APPROVAL IN ACCORDANCE WITH PERMIT PART 9.5.~~

Formatted: Heading 1, Closure Plan -Heading 1

#### ~~9.0 REFERENCES~~

~~DOE, 1995. "DOE METHODS FOR EVALUATING ENVIRONMENTAL AND WASTE MANAGEMENT SAMPLES," DOE/EM-0089T, REV. 2. PREPARED FOR THE U.S. DEPARTMENT OF ENERGY BY PACIFIC NORTHWEST LABORATORY, RICHLAND, WASHINGTON.~~

Formatted: Heading 1, Closure Plan -Heading 1, Left, Indent: Left: 0", First line: 0", Space After: 0 pt, Tab stops: Not at -1" + -0.5" + 0.3" + 0.6" + 0.9" + 1.2"

~~EPA, 1986 AND ALL APPROVED UPDATES. "TEST METHODS FOR EVALUATING SOLID WASTE, PHYSICAL/CHEMICAL METHODS," EPA-SW-846, U.S. ENVIRONMENTAL~~

Formatted: Heading 1, Closure Plan -Heading 1, Indent: Left: 0", First line: 0", Space After: 0 pt

~~PROTECTION AGENCY, OFFICE OF SOLID WASTE AND EMERGENCY RESPONSE,  
U.S. GOVERNMENT PRINTING OFFICE, WASHINGTON, D.C.~~

~~EPA, 2002. "RCRA WASTE SAMPLING DRAFT TECHNICAL GUIDANCE PLANNING,  
IMPLEMENTATION, AND ASSESSMENT," EPA530-D-02-002, AUGUST 2002, OFFICE  
OF SOLID WASTE, U.S. ENVIRONMENTAL PROTECTION AGENCY, WASHINGTON,  
DC.~~

~~NIOSH, 1994. THE NATIONAL INSTITUTE FOR OCCUPATIONAL HEALTH AND SAFETY  
(NIOSH) MANUAL OF ANALYTICAL METHODS, 4TH ED. ISSUE 1, 1994.~~

Formatted: Heading  
1,Closure Plan -Heading  
1

**TABLE G.25-1**

**CLOSURE SCHEDULE FOR THE TECHNICAL AREA 55, BUILDING 185 INDOOR  
CONTAINER STORAGE UNIT**

<b>ACTIVITY</b>	<b>MAXIMUM TIME REQUIRED</b>
<b>NOTIFY THE DEPARTMENT OF INTENT TO CLOSE.</b>	<b>-45 DAYS</b>
<b>FINAL RECEIPT OF WASTE.</b>	<b>DAY 0</b>
<b>COMPLETE WASTE REMOVAL.</b>	<b>DAY 90</b>
<b>COMPLETE A RECORDS REVIEW AND STRUCTURAL ASSESSMENT.</b>	<b>DAY 100</b>
<b>COMPLETE ALL CLOSURE ACTIVITIES AND SUBMIT FINAL CLOSURE CERTIFICATION REPORT TO THE DEPARTMENT.</b>	<b>DAY 180</b>

Formatted: Heading 1,Closure Plan -Heading 1, Left, Space Before: 0 pt, After: 0 pt

Formatted: Heading 1,Closure Plan -Heading 1, Left, Space Before: 0 pt, After: 0 pt

Formatted: Heading 1,Closure Plan -Heading 1, Left, Space Before: 0 pt, After: 0 pt

Formatted: Heading 1,Closure Plan -Heading 1, Left, Space Before: 0 pt, After: 0 pt

Formatted: Heading 1,Closure Plan -Heading 1, Left, Space Before: 0 pt, After: 0 pt

Formatted: Heading 1,Closure Plan -Heading 1, Left, Space Before: 0 pt, After: 0 pt

**TABLE G.25-2**

**POTENTIAL WASTE MATERIALS, WASTE TYPES, AND DISPOSAL OPTIONS**

<b>POTENTIAL WASTE MATERIALS</b>	<b>WASTE TYPES</b>	<b>DISPOSAL OPTIONS</b>
<b>PERSONAL PROTECTIVE EQUIPMENT (PPE)</b>	<b>NON-REGULATED SOLID WASTE</b>	<b>SUBTITLE D LANDFILL</b>
	<b>HAZARDOUS WASTE</b>	<b>THE PPE WILL BE TREATED TO MEET LAND DISPOSAL RESTRICTION (LDR) TREATMENT STANDARDS, IF NECESSARY, AND DISPOSED IN A SUBTITLE C OR D LANDFILL, AS APPROPRIATE.</b>
	<b>LOW-LEVEL RADIOACTIVE SOLID WASTE</b>	<b>EITHER AN AUTHORIZED ON-SITE RADIOACTIVE WASTE DISPOSAL AREA THAT IS NOT UNDERGOING CLOSURE UNDER RCRA OR ITS STATE ANALOG, OR AN AUTHORIZED OFF-SITE RADIOACTIVE WASTE DISPOSAL FACILITY.</b>
	<b>MIXED WASTE</b>	<b>WASTE WILL BE TREATED TO MEET LDR TREATMENT STANDARDS, IF NECESSARY, AND DISPOSED IN A SUBTITLE C OR D LANDFILL OR THE WASTE ISOLATION PILOT PLANT (WIPP), AS APPROPRIATE.</b>
<b>DECONTAMINATION WASH WATER</b>	<b>NON-REGULATED LIQUID WASTE</b>	<b>SANITARY SEWER</b>
	<b>HAZARDOUS WASTE</b>	<b>WASTE WILL BE TREATED TO MEET LDR TREATMENT STANDARDS, IF NECESSARY, AND DISPOSED IN A SUBTITLE C OR D LANDFILL, AS APPROPRIATE.</b>
	<b>RADIOACTIVE LIQUID WASTE</b>	<b>RADIOACTIVE LIQUID WASTE TREATMENT FACILITY (RLWTF)</b>

Formatted: Heading 1, Closure Plan -Heading 1

Formatted: Heading 1, Closure Plan -Heading 1, Left, Space After: 0 pt

Formatted: Heading 1, Closure Plan -Heading 1, Left, Space After: 0 pt

Formatted: Heading 1, Closure Plan -Heading 1, Left, Space After: 0 pt

Formatted: Heading 1, Closure Plan -Heading 1, Space After: 0 pt

Formatted: Heading 1, Closure Plan -Heading 1, Left, Space After: 0 pt

Formatted: Heading 1, Closure Plan -Heading 1, Left, Space After: 0 pt

Formatted: Heading 1, Closure Plan -Heading 1, Left, Space After: 0 pt

Formatted: Heading 1, Closure Plan -Heading 1, Left, Space After: 0 pt

Formatted: Heading 1, Closure Plan -Heading 1, Space After: 0 pt

Formatted: Heading 1, Closure Plan -Heading 1, Left, Space After: 0 pt

**Table G.25-2**  
**Potential Waste Materials, Waste Types, and Disposal Options**

<b>POTENTIAL WASTE MATERIALS</b>	<b>WASTE TYPES</b>	<b>DISPOSAL OPTIONS</b>
	<b>MIXED WASTE</b>	<del>WASTE WILL BE TREATED TO MEET LDR TREATMENT STANDARDS, IF NECESSARY, AND DISPOSED IN A SUBTITLE C OR D LANDFILL OR WIPP, AS APPROPRIATE.</del>
<b>METAL</b>	<b>NON-REGULATED SOLID WASTE</b>	<del>SUBTITLE D LANDFILL OR RECYCLED</del>
	<b>HAZARDOUS WASTE</b>	<del>WASTE WILL BE TREATED TO MEET LDR TREATMENT STANDARDS, IF NECESSARY, AND DISPOSED IN A SUBTITLE C OR D LANDFILL, AS APPROPRIATE.</del>
	<b>LOW-LEVEL RADIOACTIVE SOLID WASTE</b>	<del>EITHER AN AUTHORIZED ON-SITE RADIOACTIVE WASTE DISPOSAL AREA THAT IS NOT UNDERGOING CLOSURE UNDER RCRA OR ITS STATE ANALOG, OR AN AUTHORIZED OFF-SITE RADIOACTIVE WASTE DISPOSAL FACILITY.</del>
	<b>MIXED WASTE</b>	<del>WASTE WILL BE TREATED TO MEET LDR TREATMENT STANDARDS, IF NECESSARY, AND DISPOSED IN A SUBTITLE C OR D LANDFILL, OR WIPP, AS APPROPRIATE.</del>
<b>DISCARDED CONCRETE</b>	<b>LOW-LEVEL RADIOACTIVE SOLID WASTE</b>	<del>EITHER AN AUTHORIZED ON-SITE RADIOACTIVE WASTE DISPOSAL AREA THAT IS NOT UNDERGOING CLOSURE UNDER RCRA OR ITS STATE ANALOG.</del>
	<b>MIXED WASTE</b>	<del>WASTE WILL BE TREATED TO MEET LDR TREATMENT STANDARDS, IF NECESSARY, AND DISPOSED IN A SUBTITLE C OR D LANDFILL OR WIPP, AS APPROPRIATE.</del>

Formatted: Heading 1, Closure Plan -Heading 1, Left, Space After: 0 pt

Formatted: Heading 1, Closure Plan -Heading 1, Left, Space After: 0 pt

Formatted: Heading 1, Closure Plan -Heading 1, Left, Space After: 0 pt

Formatted: Heading 1, Closure Plan -Heading 1, Left, Space After: 0 pt

Formatted: Heading 1, Closure Plan -Heading 1, Left, Space After: 0 pt

Formatted: Heading 1, Closure Plan -Heading 1, Space After: 0 pt

Formatted: Heading 1, Closure Plan -Heading 1, Left, Space After: 0 pt

Formatted: Heading 1, Closure Plan -Heading 1, Left, Space After: 0 pt

Formatted: Heading 1, Closure Plan -Heading 1, Space After: 0 pt

Formatted: Heading 1, Closure Plan -Heading 1, Left, Space After: 0 pt

**Table G.25-2  
 Potential Waste Materials, Waste Types, and Disposal Options**

<b>POTENTIAL WASTE MATERIALS</b>	<b>WASTE TYPES</b>	<b>DISPOSAL OPTIONS</b>
	<b>NON-REGULATED SOLID WASTE</b>	<b>SUBTITLE D LANDFILL, RECYCLED, OR REUSED</b>
	<b>HAZARDOUS WASTE</b>	<b>WASTE WILL BE TREATED TO MEET LDR TREATMENT STANDARDS, IF NECESSARY, AND DISPOSED IN A SUBTITLE C OR D LANDFILL, AS APPROPRIATE.</b>
<b>DISCARDED WASTE MANAGEMENT EQUIPMENT</b>	<b>LOW-LEVEL RADIOACTIVE SOLID WASTE</b>	<b>EITHER AN AUTHORIZED ON-SITE RADIOACTIVE WASTE DISPOSAL AREA THAT IS NOT UNDERGOING CLOSURE UNDER RCRA OR ITS STATE ANALOG, OR AN AUTHORIZED OFF-SITE RADIOACTIVE WASTE DISPOSAL FACILITY.</b>
	<b>MIXED WASTE</b>	<b>WASTE WILL BE TREATED TO MEET LDR TREATMENT STANDARDS, IF NECESSARY, AND DISPOSED IN A SUBTITLE C OR D LANDFILL OR WIPP, AS APPROPRIATE.</b>
	<b>NON-REGULATED SOLID WASTE</b>	<b>SUBTITLE D LANDFILL</b>
	<b>HAZARDOUS WASTE</b>	<b>WASTE WILL BE TREATED TO MEET LDR TREATMENT STANDARDS, IF NECESSARY, AND DISPOSED IN A SUBTITLE C OR D LANDFILL, AS APPROPRIATE.</b>
<b>SAMPLING EQUIPMENT</b>	<b>LOW-LEVEL RADIOACTIVE SOLID WASTE</b>	<b>EITHER AN AUTHORIZED ON-SITE RADIOACTIVE WASTE DISPOSAL AREA THAT IS NOT UNDERGOING CLOSURE UNDER RCRA OR ITS STATE ANALOG, OR AN AUTHORIZED OFF-SITE RADIOACTIVE WASTE DISPOSAL FACILITY.</b>

Formatted: Heading 1, Closure Plan -Heading 1, Left, Space After: 0 pt

Formatted: Heading 1, Closure Plan -Heading 1, Left, Space After: 0 pt

Formatted: Heading 1, Closure Plan -Heading 1, Left, Space After: 0 pt

Formatted: Heading 1, Closure Plan -Heading 1, Left, Space After: 0 pt

Formatted: Heading 1, Closure Plan -Heading 1, Left, Space After: 0 pt

Formatted: Heading 1, Closure Plan -Heading 1, Space After: 0 pt

Formatted: Heading 1, Closure Plan -Heading 1, Left, Space After: 0 pt

Formatted: Heading 1, Closure Plan -Heading 1, Left, Space After: 0 pt

Formatted: Heading 1, Closure Plan -Heading 1, Left, Space After: 0 pt

Formatted: Heading 1, Closure Plan -Heading 1, Space After: 0 pt

**Table G.25-2**  
**Potential Waste Materials, Waste Types, and Disposal Options**

<b>POTENTIAL WASTE MATERIALS</b>	<b>WASTE TYPES</b>	<b>DISPOSAL OPTIONS</b>
	<b>MIXED WASTE</b>	<del>WASTE WILL BE TREATED TO MEET LDR TREATMENT STANDARDS, IF NECESSARY, AND DISPOSED IN A SUBTITLE C OR D LANDFILL OR WIPP, AS APPROPRIATE.</del>
	<b>NON-REGULATED SOLID WASTE</b>	<b>SUBTITLE D LANDFILL</b>
	<b>HAZARDOUS WASTE</b>	<del>WASTE WILL BE TREATED TO MEET LDR TREATMENT STANDARDS, IF NECESSARY, AND DISPOSED IN A SUBTITLE C OR D LANDFILL, AS APPROPRIATE.</del>

Formatted: Heading 1, Closure Plan -Heading 1, Left, Space After: 0 pt

Formatted: Heading 1, Closure Plan -Heading 1, Left, Space After: 0 pt

Formatted: Heading 1, Closure Plan -Heading 1, Left, Space After: 0 pt

Formatted: Heading 1, Closure Plan -Heading 1, Left, Space After: 0 pt





<b>COMPOUNDS (TIC)</b>				
<b>TARGET COMPOUND LIST SVOCs PLUS 20 TICS</b>	<b>8270D-C</b>	<b>GC/MS</b>	<b>10 MG/L</b>	<b>DETERMINE THE SVOCs CONCENTRATION IN THE SAMPLES.</b>

<sup>A</sup> ~~U.S. ENVIRONMENTAL PROTECTION AGENCY (EPA), 1986 AND ALL APPROVED UPDATES, "TEST METHODS FOR EVALUATING SOLID WASTE, PHYSICAL/CHEMICAL METHODS," SW-846.~~

<sup>B</sup> ~~DETECTION LIMITS LISTED FOR METALS ARE FOR CLEAN WATER. ACTUAL DETECTION LIMITS MAY BE HIGHER DEPENDING ON SAMPLE COMPOSITION AND MATRIX TYPE.~~

<sup>C</sup> ~~METHOD BEING INTEGRATED INTO METHOD 7010, PER THE MAY 1998 SW-846 DRAFT UPDATE IVA.~~

<sup>D</sup> ~~METHOD BEING INTEGRATED INTO METHOD 7000B, PER THE MAY 1998 SW-846 DRAFT UPDATE IVA.~~

<sup>E</sup> ~~METHOD BEING REVISED TO 7471B PER THE MAY 1998 SW-846 DRAFT UPDATE IVA.~~

~~CVAA = COLD-VAPOR ATOMIC ABSORPTION SPECTROSCOPY  
 FLAA = FLAME ATOMIC ABSORPTION SPECTROSCOPY  
 GFAA = GRAPHITE FURNACE ATOMIC ABSORPTION SPECTROSCOPY  
 UG/L = MICROGRAMS PER LITER.~~

Formatted: Heading 1, Closure Plan -Heading 1, Left, Tab stops: Not at 0"

Formatted: Heading 1, Closure Plan -Heading 1, Tab stops: Not at 0.01"

Formatted: Heading 1, Closure Plan -Heading 1, Left, Indent: Left: 0", First line: 0", Tab stops: Not at 0.25"

Formatted: Heading 1, Closure Plan -Heading 1, Indent: Left: 0", First line: 0", Tab stops: Not at 0.25"

Formatted: Heading 1, Closure Plan -Heading 1

Formatted: Heading 1, Closure Plan -Heading 1, Left

Formatted: Heading 1, Closure Plan -Heading 1

**TABLE G.25-4**

**SAMPLE CONTAINERS<sup>A</sup>, PRESERVATION TECHNIQUES, AND HOLDING TIMES<sup>B</sup>**

ANALYTE CLASS AND SAMPLE TYPE	CONTAINER TYPE AND MATERIALS	PRESERVATION	HOLDING TIME
<b>METALS</b>			
<b>TCLP/TOTAL METALS: ARSENIC, BARIUM, CADMIUM, CHROMIUM, LEAD, SELENIUM, SILVER</b>	<b>AQUEOUS MEDIA: 500-ML WIDE MOUTH- POLYETHYLENE OR GLASS WITH TEFLON LINER</b>	<b>AQUEOUS MEDIA: HNO<sub>3</sub> TO PH &lt;2 COOL TO 4 °C</b>	<b>180 DAYS</b>
	<b>SOLID MEDIA: 125-ML GLASS</b>	<b>SOLID MEDIA: COOL TO 4 °C</b>	
<b>TCLP/TOTAL MERCURY</b>	<b>AQUEOUS MEDIA: 500-ML WIDE MOUTH- POLYETHYLENE OR GLASS WITH TEFLON LINER</b>	<b>AQUEOUS MEDIA: HNO<sub>3</sub> TO PH &lt;2 COOL TO 4 °C</b>	<b>28 DAYS</b>
	<b>SOLID MEDIA: 125-ML GLASS</b>	<b>SOLID MEDIA: COOL TO 4 °C</b>	
<b>VOLATILE ORGANIC COMPOUNDS</b>			
<b>TARGET COMPOUND VOLATILE ORGANIC COMPOUNDS</b>	<b>AQUEOUS MEDIA: TWO 40-ML AMBER GLASS VIALS WITH TEFLON- LINED SEPTA</b>	<b>AQUEOUS MEDIA: HCL TO PH &lt;2 COOL TO 4 °C</b>	<b>14 DAYS</b>
	<b>SOLID MEDIA: 125-ML GLASS OR TWO 40-</b>	<b>SOLID MEDIA COOL TO 4 °C</b>	

Formatted: Heading 1,Closure Plan -Heading 1, Left, Space After: 0 pt

Formatted: Heading 1,Closure Plan -Heading 1, Left, Space After: 0 pt

Formatted: Heading 1,Closure Plan -Heading 1, Space After: 0 pt

Formatted: Heading 1,Closure Plan -Heading 1, Right: 0", Space After: 0 pt

Formatted: Heading 1,Closure Plan -Heading 1, Space After: 0 pt

Formatted: Heading 1,Closure Plan -Heading 1, Left, Indent: Left: 0", First line: 0", Tab stops: Not at 0.25"

Formatted: Heading 1,Closure Plan -Heading 1

Formatted: Heading 1,Closure Plan -Heading 1, Indent: Left: 0", First line: 0", Tab stops: Not at 0.25"

Formatted: Heading 1,Closure Plan -Heading 1, Indent: Left: 0"



**TABLE G.25-5**

**QUALITY CONTROL SAMPLE TYPES, APPLICABLE ANALYSES, FREQUENCY, AND ACCEPTANCE CRITERIA**

<b>QC SAMPLE TYPE</b>	<b>APPLICABLE ANALYSIS</b>	<b>FREQUENCY</b>	<b>ACCEPTANCE CRITERIA</b>
<b>FIELD BLANK</b>	<b>METALS</b>	<b>ONE SAMPLE DAILY PER ANALYSIS</b>	<b>NOT APPLICABLE</b>
<b>FIELD DUPLICATE</b>	<b>CHEMICAL</b>	<b>ONE FOR EACH SAMPLING SEQUENCE</b>	<b>RELATIVE PERCENT DIFFERENCE LESS THAN OR EQUAL TO 20 PERCENT</b>
<b>EQUIPMENT RINSATE BLANK<sup>A</sup></b>	<b>METALS</b>	<b>ONE SAMPLE DAILY</b>	<b>NOT APPLICABLE</b>

<sup>A</sup> **COLLECTED ONLY IF REUSABLE SAMPLING EQUIPMENT USED.**

Formatted: Heading 1, Closure Plan -Heading 1, Left, Space After: 0 pt

Formatted: Heading 1, Closure Plan -Heading 1, Space After: 0 pt

Formatted: Heading 1, Closure Plan -Heading 1, Space After: 0 pt

Formatted: Heading 1, Closure Plan -Heading 1, Space After: 0 pt

Formatted: Heading 1, Closure Plan -Heading 1, Left, Tab stops: Not at 0.25"

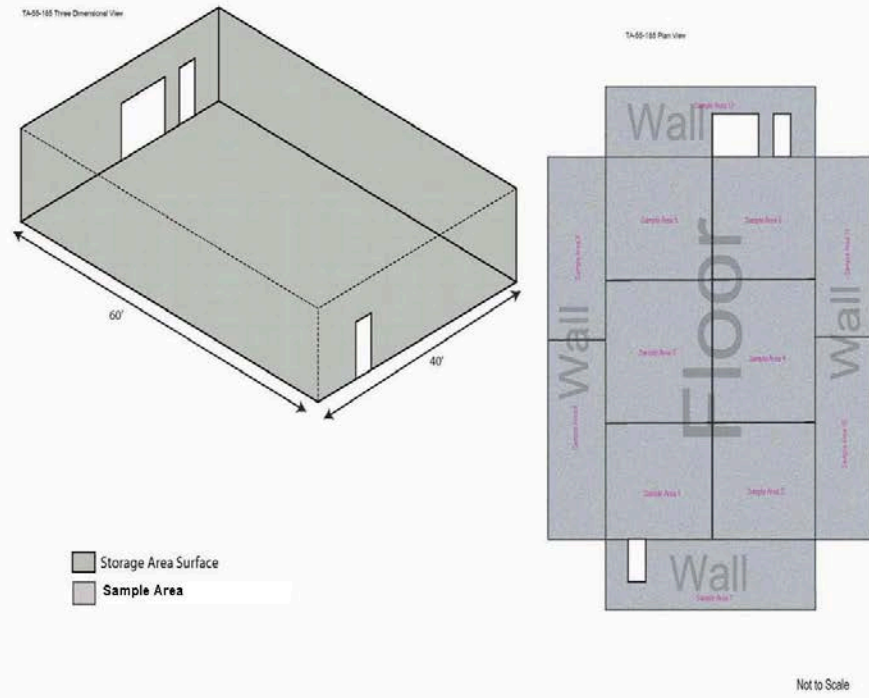

Formatted: Heading 1, Closure Plan -Heading 1, Left, Indent: Left: 0", First line: 0"

**FIGURE G.25-1: TECHNICAL AREA 55, BUILDING 185, INDOOR CONTAINER STORAGE UNIT GRID SAMPLING LOCATIONS**